

metal
expert

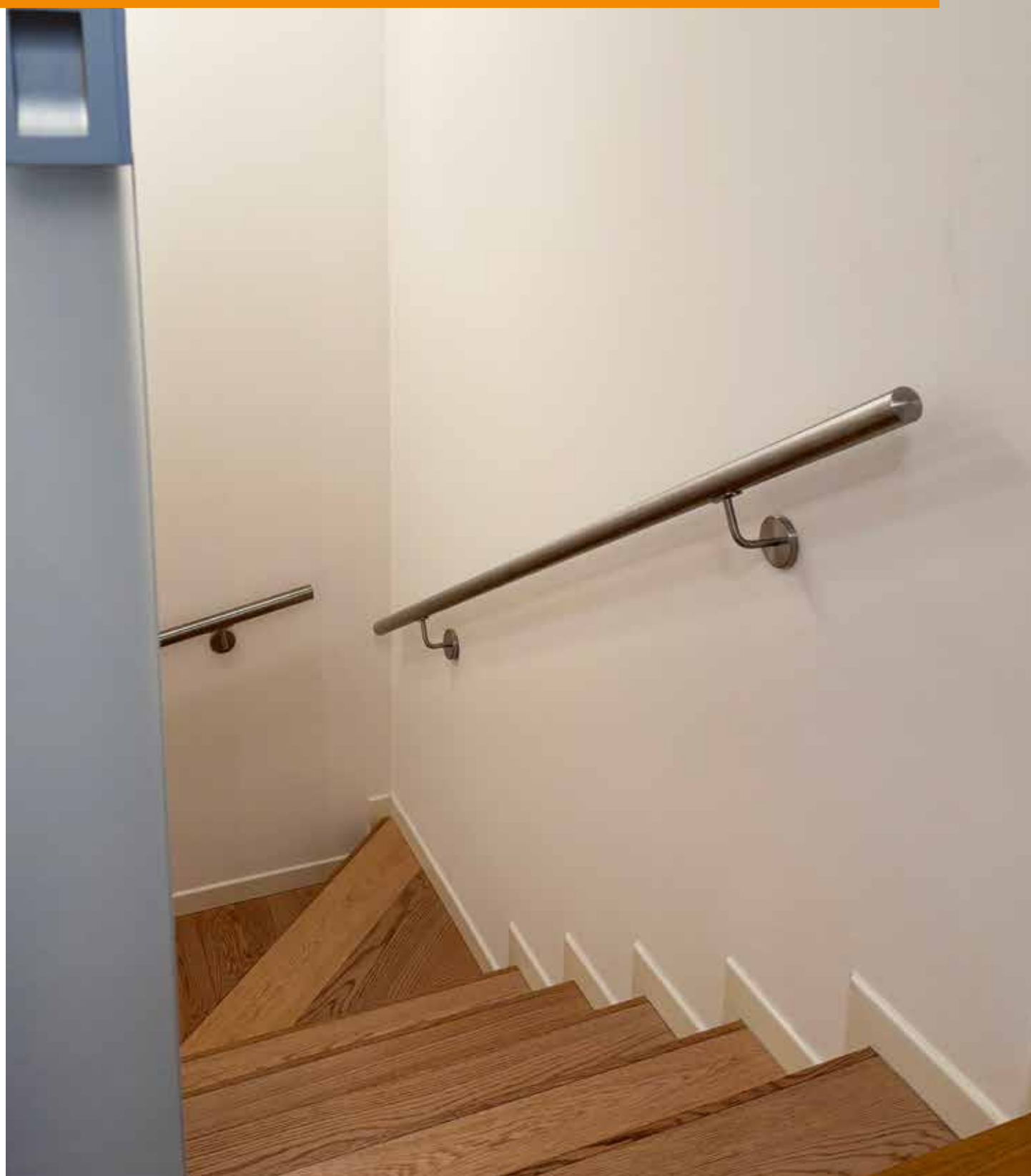

HANDRAIL

Technical information and
assembly instructions





JOINTS

CODE	MATERIAL AND FINISH	TYPE	REFERENCE
E455/304M	AISI304 satin	Articulated for handrail Ø 42.4 x 2.0 mm	"F"
E450/304M	AISI304 satin	90° for handrail Ø 42.4 x 2.0 mm	"V"
E446/304M	AISI304 satin	Linear for handrail Ø 42.4 x 2.0 mm	"G"

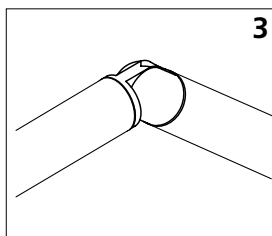
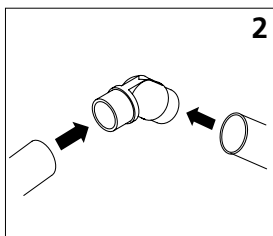
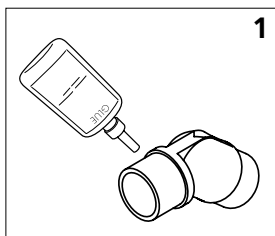
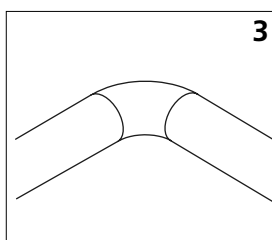
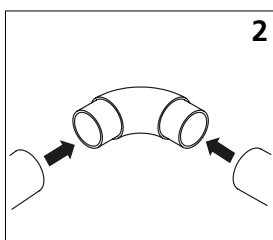
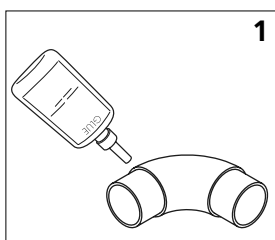
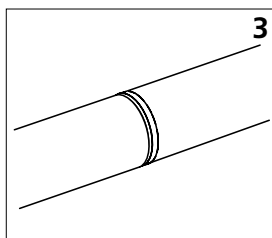
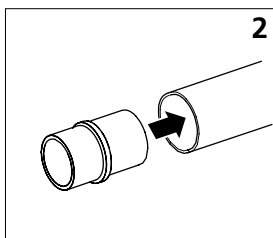
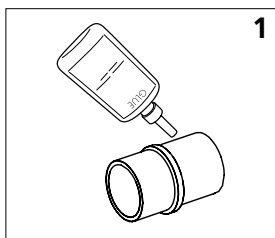

Clean surfaces with isopropyl alcohol or acetone before using the adhesive. Apply anaerobic metal adhesive (Art. No. E4054/SM).

Insert the joint using a rubber mallet if necessary.

Before the glue hardens, which varies depending on temperature and humidity, make sure that the component is properly inserted.



END CAPS

CODE	MATERIAL AND FINISH	TYPE	REFERENCE
E316/304M	AISI304 satin	For handrail Ø 42,4 x 2,0 mm	"H"

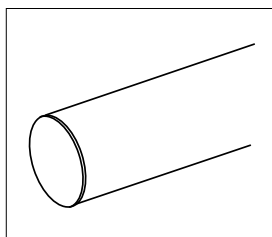
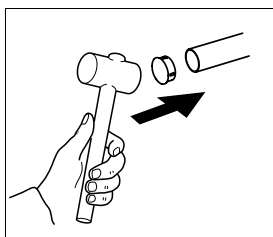
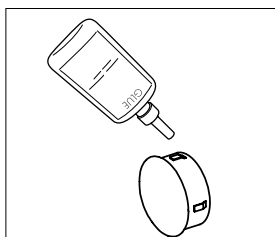

Clean surfaces with isopropyl alcohol or acetone before using the adhesive. Apply anaerobic metal adhesive (Art. No. E4054/SM).

Insert the cap using a rubber mallet if necessary.

Before the glue hardens, which varies depending on temperature and humidity, make sure that the component is properly inserted.



HANDRAIL

CODE	MATERIAL AND FINISH	LENGTH	SECTION	REFERENCE
E001/1500M	AISI304 satin	1,5 mt	Ø 42,4 x 2,0 mm	"E"

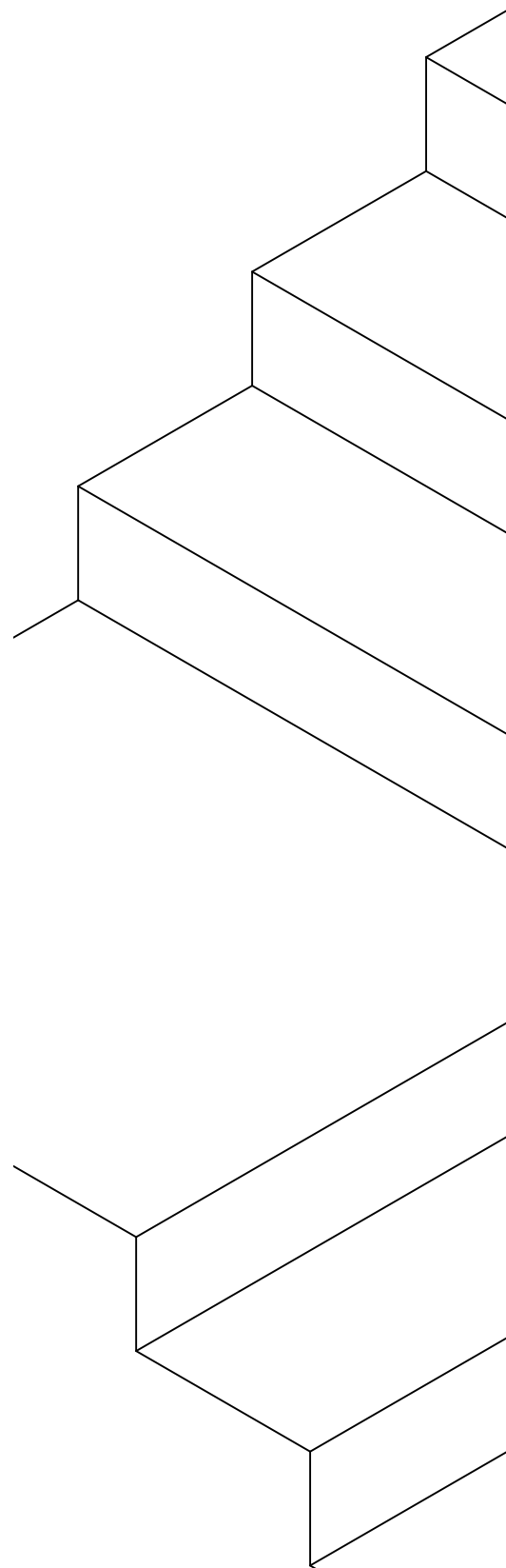



HANDRAIL SUPPORT

CODE	MATERIAL AND FINISH	TYPE	SECTION	REFERENCE
E119710104M	AISI304 satinato	Ring	Ø 42,4 x 2,0 mm	"U"

INSTALLATION OF HANDRAIL SUPPORTS

Before using an adhesive, clean surfaces with isopropyl alcohol or acetone.



Caution! Always loosen the grub screws before passing the bars. The tip of the grub screws may rub against the bars.

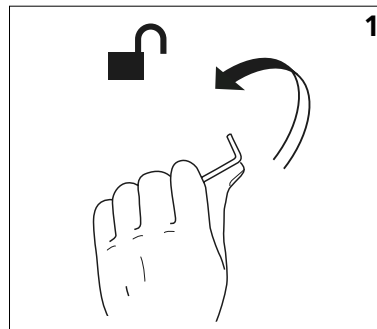

Opening the grain

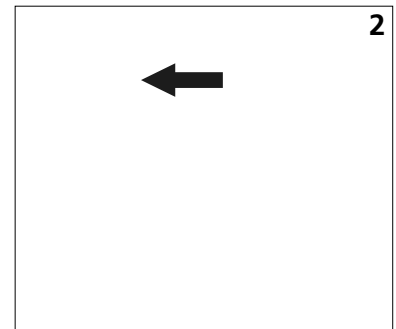

Inserting the handrail

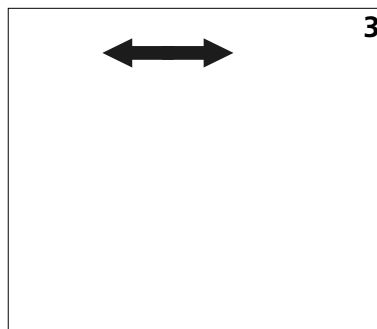

Adjust the position of the handrail holder

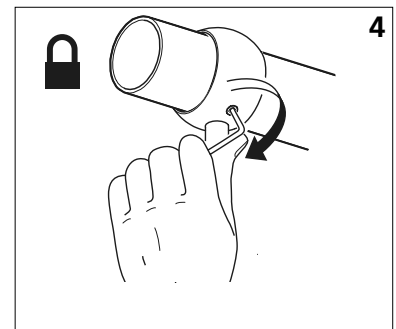

Tighten the dowel

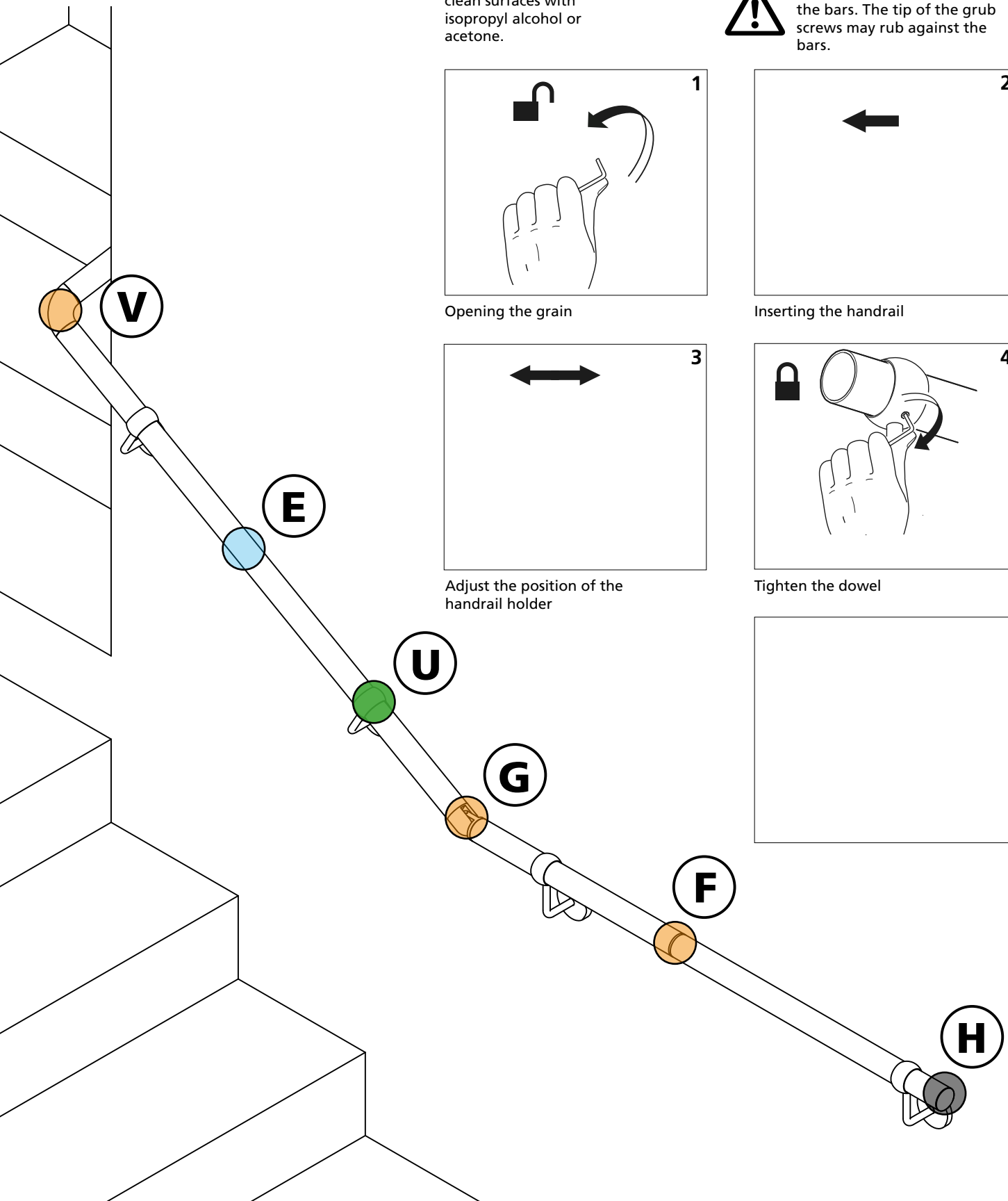



Scan the QR Code Installation video tutorial
or go to the video section on the metal-expert.com website

Our kit handrails

The Metal Expert range offers various handrail kits, adaptable to every need thanks to a wide selection of accessories.

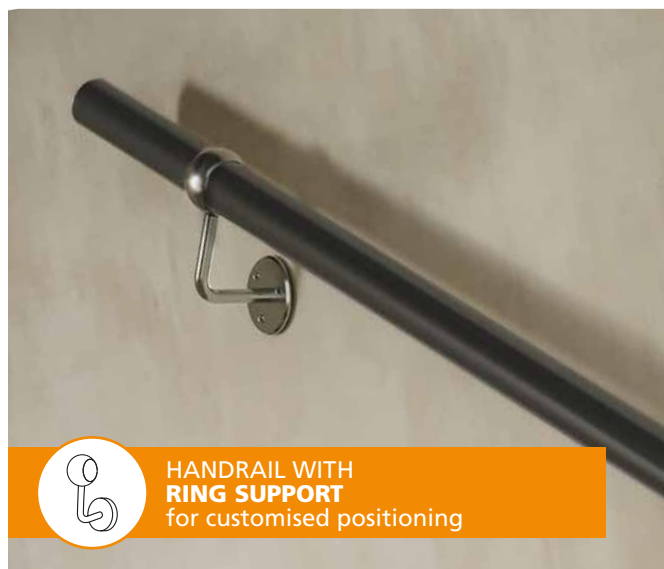





	Code	Material	Finish	Colour	Handrail support	Ø Tube	Length	A	Installation
STAINLESS STEEL	E090M	Stainless steel AISI 304	Satin	Steel		Ø 42,4 x 2,0 mm	2000 mm	1500 mm	
	E091M	Stainless steel AISI 304	Satin	Steel		Ø 42,4 x 2,0 mm	3000 mm	1250 mm	
	E090316M	Stainless steel AISI 316	Satin	Steel		Ø 42,4 x 2,0 mm	2000 mm	1500 mm	
	E091316M	Stainless steel AISI 316	Satin	Steel		Ø 42,4 x 2,0 mm	3000 mm	1250 mm	
	X090M	Stainless steel AISI 316	Polished	Steel		Ø 42,4 x 2,0 mm	2000 mm	1500 mm	
	X091M	Stainless steel AISI 316	Polished	Steel		Ø 42,4 x 2,0 mm	3000 mm	1250 mm	
	E0930M	Stainless steel AISI 304	Satin	Steel		Ø 42,4 x 2,0 mm	2000 mm	1500 mm	
	E0931M	Stainless steel AISI 304	Satin	Steel		Ø 42,4 x 2,0 mm	3000 mm	1250 mm	
	E0930316M	Stainless steel AISI 316	Satin	Steel		Ø 42,4 x 2,0 mm	2000 mm	1500 mm	
STAINLESS STEEL AND PAINTED GALVANISED IRON	E0931316M	Stainless steel AISI 316	Satin	Steel		Ø 42,4 x 2,0 mm	3000 mm	1250 mm	
	E0991M	Stainless steel AISI 304	Satin	Steel		Ø 42,4 x 2,0 mm	1500 mm	1100 mm	
	E0990M	Iron	Painted matt	Anthracite grey ral 7021		Ø 42,4 x 2,0 mm	1500 mm	1100 mm	
	E0903M	Iron galvanised	Painted matt	Anthracite grey ral 7021		Ø 42,4 x 2,0 mm	2000 mm	1500 mm	
	E09033000M	Iron galvanised	Painted matt	Anthracite grey ral 7021		Ø 42,4 x 2,0 mm	3000 mm	1250 mm	
	E0904M	Iron galvanised	Painted matt	Rust clear		Ø 42,4 x 2,0 mm	2000 mm	1500 mm	
	E09043000M	Iron galvanised	Painted matt	Rust clear		Ø 42,4 x 2,0 mm	3000 mm	1250 mm	
	E0922M	Iron galvanised	Painted matt	Light grey ral 7036		Ø 42,4 x 2,0 mm	2000 mm	1500 mm	
	E0923M	Iron galvanised	Painted matt	Brown ral 8019		Ø 42,4 x 2,0 mm	2000 mm	1500 mm	

QUADRO

Square corners and strong lines for this steel model, which is available in a version equipped with a saddle holder.



2000 mm Model				3000 mm Model				
Code	Material	Finish	Colour	Handrail support	Tube	Length	A	Installation
E095M	Stainless steel AISI 304	Satin	Steel		40 x 40 x 2,0 mm	2000 mm	1500 mm	 
E096M	Stainless steel AISI 304	Satin	Steel		40 x 40 x 2,0 mm	3000 mm	1250 mm	 

LUMEN - LED*

Two different versions: round or square but both with integrated LED lighting. A practical solution that discreetly illuminates the space in which it is installed, offering greater safety in use.



2000 mm Model				3000 mm Model				
Code	Material	Finish	Colour	Handrail support	Tube	Length	A	Installation
E119710013M	Stainless steel AISI 316	Satin	Steel		40 x 40 x 2,0 mm	2000 mm	1500 mm	 
E119710014M	Stainless steel AISI 316	Satin	Steel		40 x 40 x 2,0 mm	2000 mm	1500 mm	 

*LED system with ballast included



Gonzato Group Italy

Via Vicenza, 6/14
36034 Malo (Vicenza) Italy
T +39 0445 580 580
F +39 0445 580 874

For information:
info@metal-expert.com
www.metal-expert.com